

OVERALL DIMENSIONS

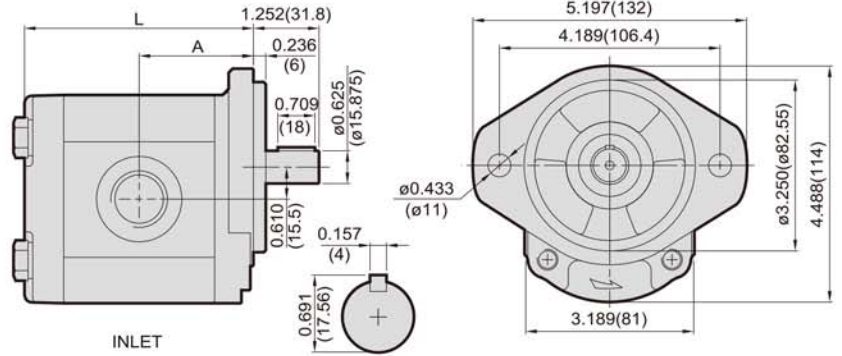

CW(R) NON ARROW CCW(L) DIRECTION OF ROTATION : LOOKING ON DRIVE SHAFT

ORDERING EXAMPLE

For Example **2** **G** **G** **1** **U**

SERIES TYPE FLANGE SHAFT PORT DISPL. ROTATION

If you need pump with displ.0.98 c.i.r and rotation is cw, the model number is : **2GG1U16R**

PERFORMANCE DATA

MODEL	DISPLACEMENT		PRESSURE psi(MPa)		RPM RANGE	DIMENSIONS inch (mm)		WEIGHT	
	c.i.r	cm ³ /r	CONTINUOUS	MAX.		A	L	Kg	LBS
04	0.24	4.0	3500(25)	4200(30)	600	1.658(42.1)	3.433(87.2)	3.23	7.11
05	0.30	5.0	3500(25)	4200(30)		1.687(42.9)	3.493(88.7)	3.27	7.19
06	0.38	6.2	3500(25)	4200(30)		1.717(43.6)	3.552(90.2)	3.32	7.30
07	0.43	7.0	3500(25)	4200(30)		1.746(44.4)	3.611(91.7)	3.36	7.39
08	0.52	8.4	3500(25)	4200(30)		1.796(45.6)	3.709(94.2)	3.41	7.50
09	0.58	9.5	3500(25)	4200(30)		1.825(46.4)	3.768(95.7)	3.45	7.59
11	0.69	11.3	3500(25)	4200(30)		1.884(47.9)	3.886(98.7)	3.53	7.77
14	0.85	14.0	3500(25)	4200(30)		1.963(49.9)	4.044(102.7)	3.64	8.01
16	0.98	16.0	3500(25)	4200(30)		2.002(51.4)	4.162(105.7)	3.74	8.23
18	1.10	18.0	3500(25)	4200(30)	2.081(52.9)	4.280(108.7)	3.80	8.36	
20	1.20	19.5	3300(23)	3800(27)	2.160(54.9)	4.437(112.7)	3.89	8.56	
22	1.31	21.5	3000(21)	3500(25)	2.180(55.4)	4.477(113.7)	3.96	8.71	
24	1.44	23.5	2550(18)	3100(22)	2.258(57.4)	4.634(117.7)	4.01	8.82	
26	1.53	25.0	2550(18)	3100(22)	2.317(58.9)	4.752(120.7)	4.10	9.02	
28	1.71	28.0	2300(16)	2700(19)	2.396(60.9)	4.910(124.7)	4.19	9.22	
30	1.84	30.0	2100(15)	2550(18)	2.475(62.9)	5.067(128.7)	4.30	9.46	
33	2.02	33.0	2000(14)	2300(16)	2.554(64.9)	5.225(132.7)	4.41	9.70	

*More than 2500 qualified per applications.

DRIVE SHAFTS

SUITABLE FOR **C E R** FLANGE

DRIVE SHAFTS

SUITABLE FOR **G** FLANGE

■ MOUNTING FLANGES

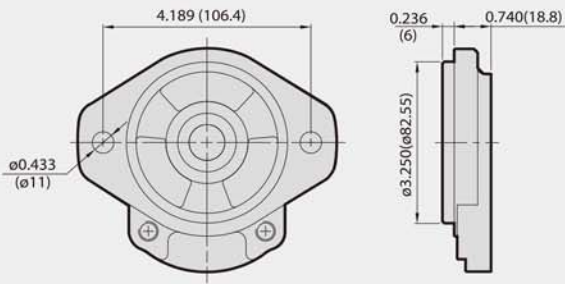

2G & 2D Series-Code:G
2M Series-Code:M

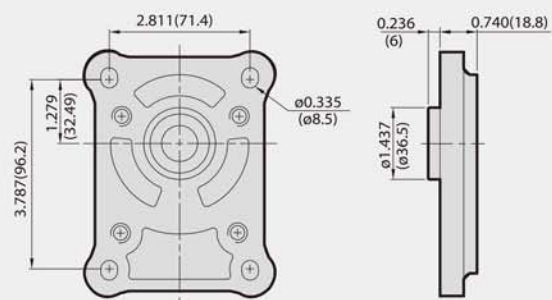

Code:C

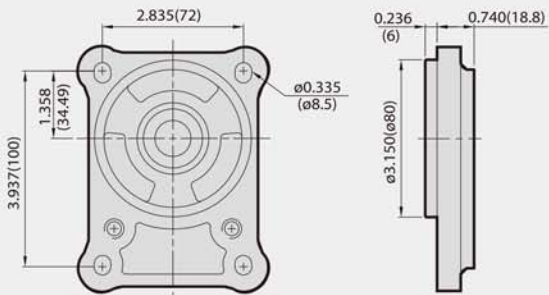

Code:E

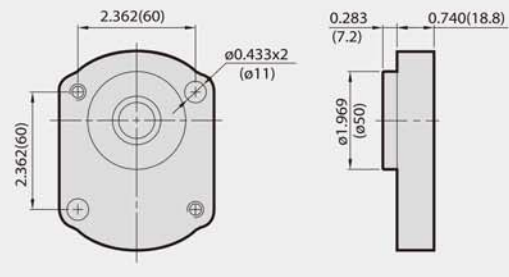

Code:R

■ PORTS

UNF

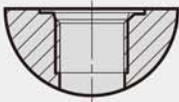

Code	From "04" to "22"		From "24" to "33"	
	INLET	OUTLE	INLET	OUTLET
U	UNF# 12 1-1/16"-12	UNF# 10 7/8"-14	UNF# 16 1-5/16"-12	UNF# 12 1-1/16"-12

PT 、 NPT 、 BSPF

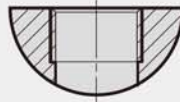

Code	From "04" to "22"		From "24" to "33"	
	INLET	OUTLE	INLET	OUTLET
P	PT 3/4"	PT 1/2"	PT 1"	PT 3/4"
N	NPT 3/4"	NPT 1/2"	NPT 1"	NPT 3/4"
B	BSPF 3/4"	BSPF 1/2"	BSPF 1"	BSPF 3/4"

REAR PORT

FOR "2G SERIES" ONLY



Code	From "04" to "33"	
	INLET	OUTLET
Z	UNF# 16 1-5/16"-12	UNF# 12 1-1/16"-12
Y	PT 1"	PT 3/4"

FLANGE (SQUARE)

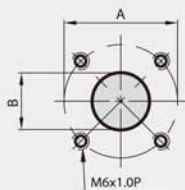

Code	From "04" to "33"			
	INLET		OUTLET	
	A	B	A	B
F	1.575 (1.575)	0.787 (20)	1.380 (35)	0.591 (15)

FLANGE (DIAMOND)

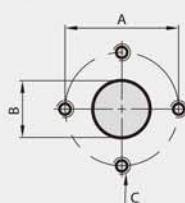

Code	From "04" to "33"					
	INLET			OUTLET		
	A	B	C	A	B	C
E	1.575 (1.575)	0.748 (19)	M8 X 1.25P	1.181 (30)	0.512 (13)	M6 X 1.0P

2G/2D/2T SERIES PERFORMANCE CURVE

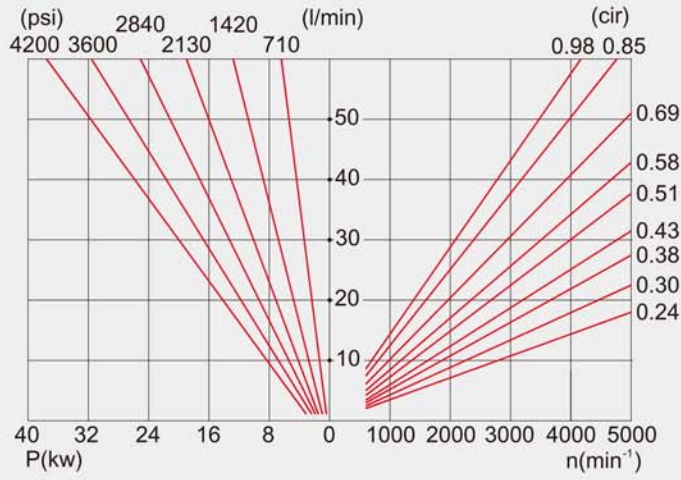

GROUP 2

2G/2D/2T SERIES PERFORMANCE CURVE

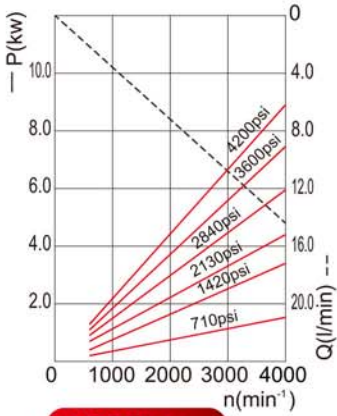

MODEL:04

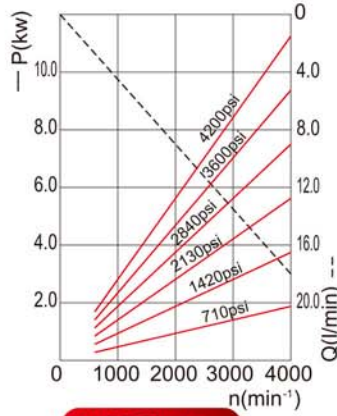

MODEL:05

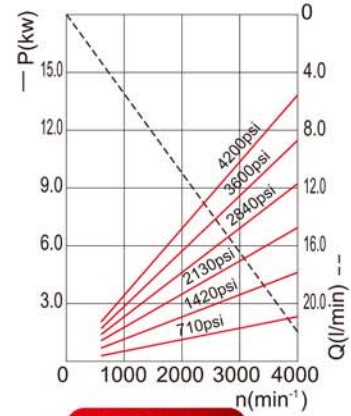

MODEL:06

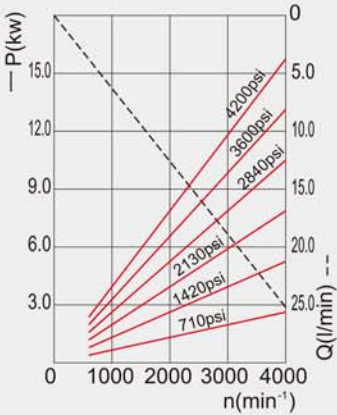

MODEL:07

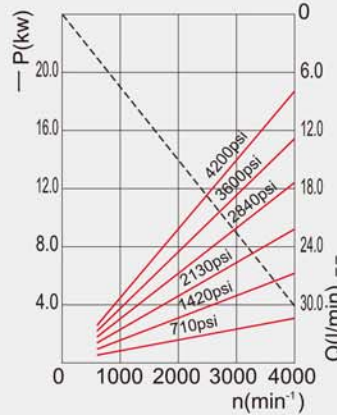

MODEL:08

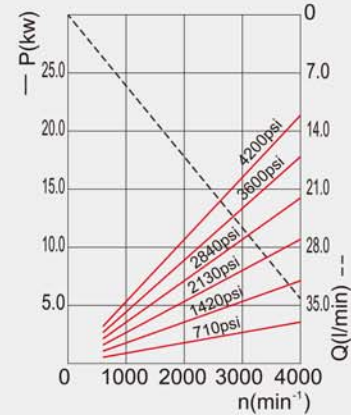

MODEL:09

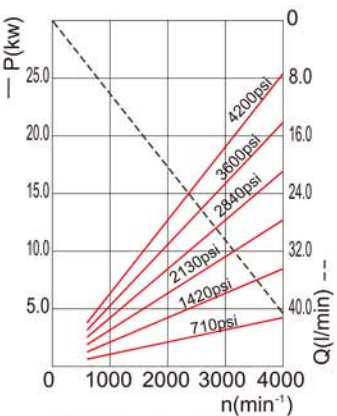

MODEL:11

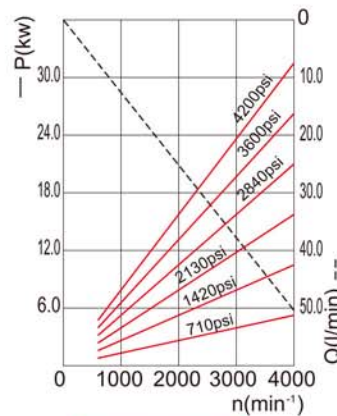

MODEL:14

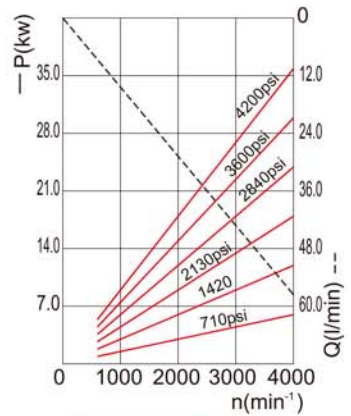

MODEL:16

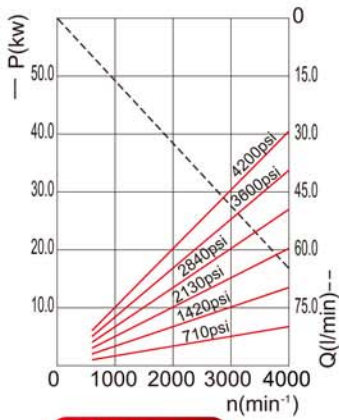
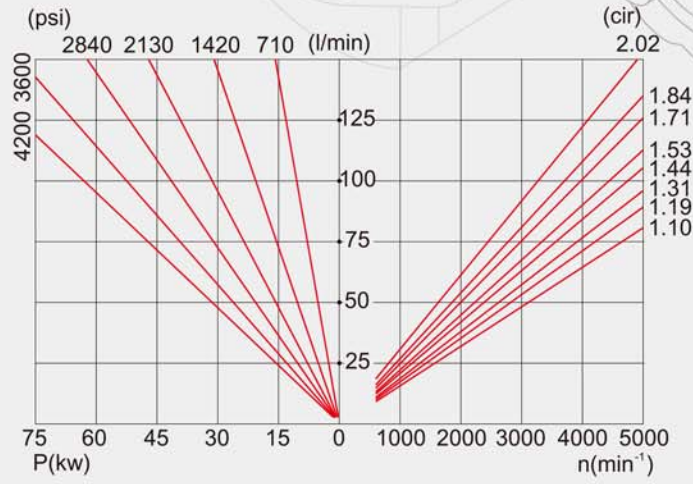

MODEL:18

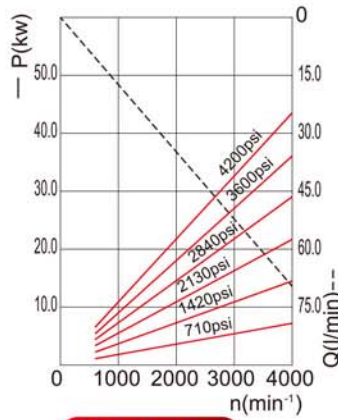

MODEL:20

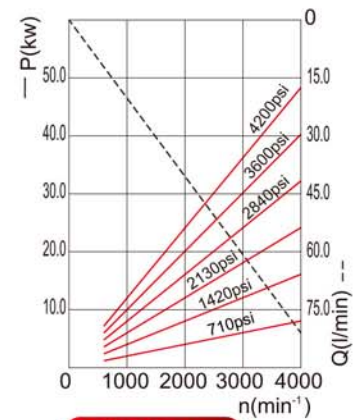

MODEL:22

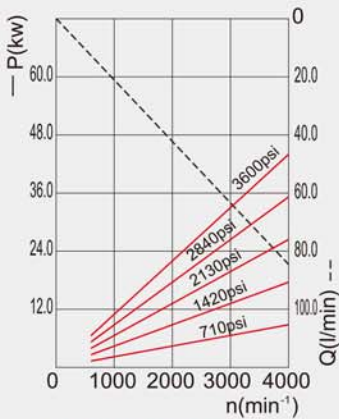

MODEL:24

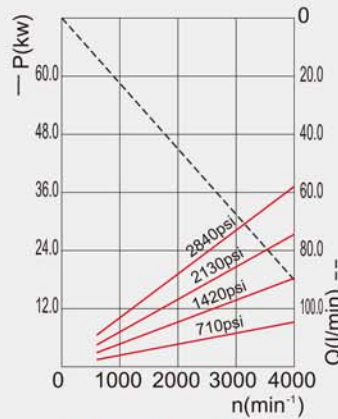

MODEL:26

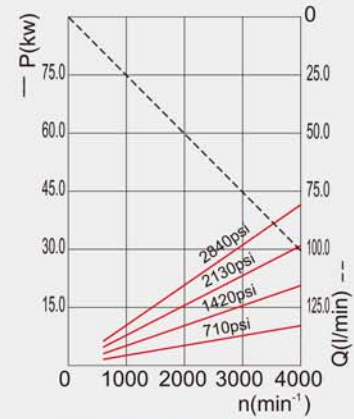

MODEL:28

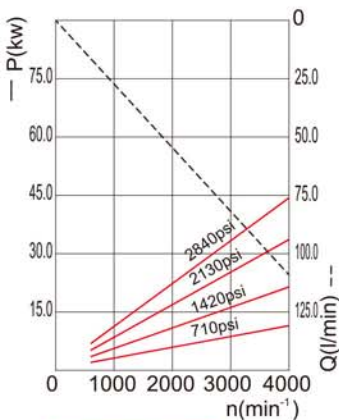

MODEL:30

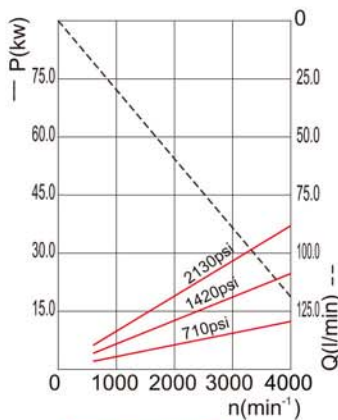

MODEL:33